

# VA04 1920'S POWER GLIDER

**KIT** Rubber Band Powered 皮筋动力

**DANCING WINGS HOBBY**

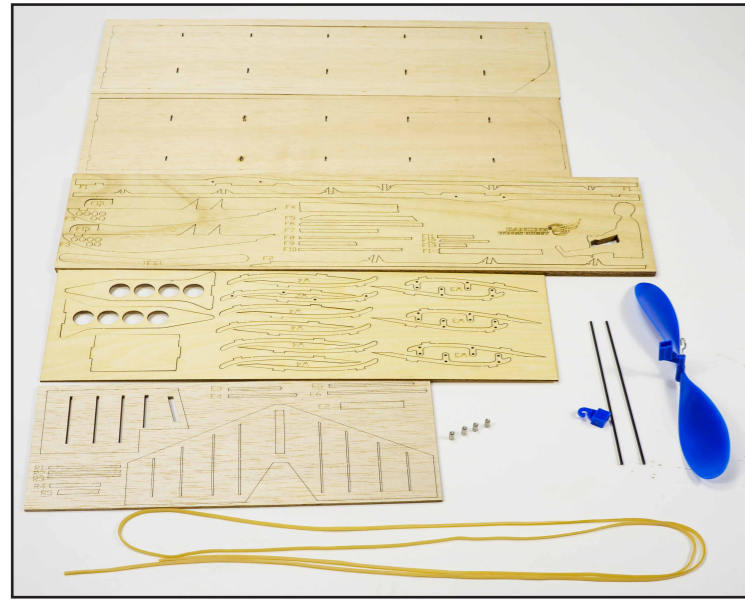

**关于KIT机型:**

**About Balsa KIT models:**

所有的KIT机型均由激光切割机切割完成。在结构强度处比如翼肋、主梁处我们会选用椴木/桐木来制作，在其他的地方我们都会选用巴尔杉木来制作，以确保能有最好的飞行效果。  
All Balsa KIT models are cut by laser cutting machine. In order to ensure the structural strength, we will select basswood or paulownia wood at the wing ribs and main beams, and balsa wood in other places to ensure the best flight effect.

在拼装过程中，需要用到胶水，工具和一定的动手能力。In the assembly process, glue and other tools need to be used; the man who assembled the plane needs to have a certain assembling ability.

只需要1-2个小时，就可以带着拼装好的飞机去公园体验下飞行的乐趣了。Only 1-2 hours to complete the assembly, and you can take the assembled plane to the park to experience the fun of flying.

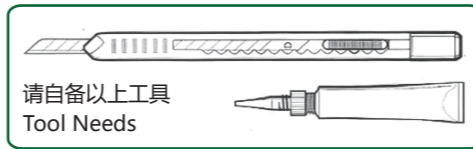

## Let's play!

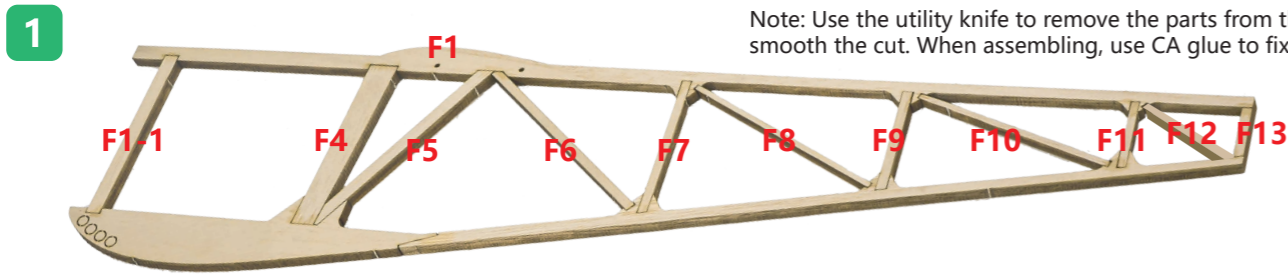

注意：用美工刀从板材上取下零件，切口处需打磨平整。拼装时连接处用适量CA胶粘固。

Note: Use the utility knife to remove the parts from the board, and smooth the cut. When assembling, use CA glue to fix the connection.



2 注意粘贴T型加固片。Pay attention to the T-shaped reinforcement sheet.

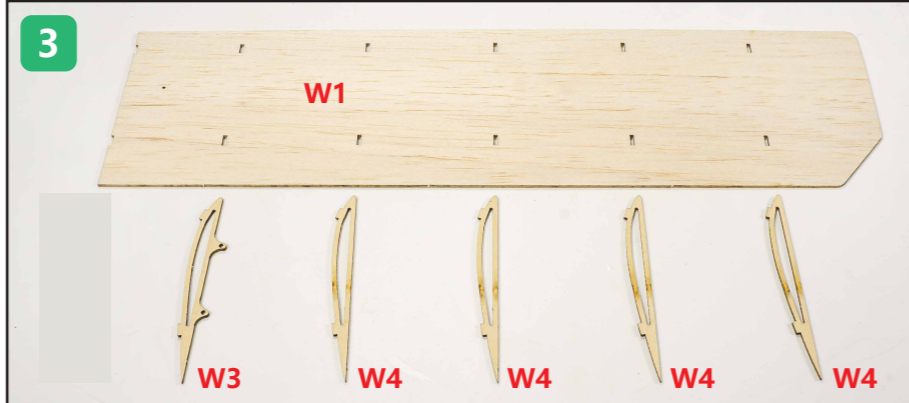

拼装前先将雕刻接缝处打磨平滑  
Sand and smooth the engraved joints before assembling.

安装机翼翼肋前，请先使用湿的纸巾擦拭左图机翼正面蓝色区域，软化巴尔杉木，以方便在机翼背面安装翼肋。  
Before installing the wing ribs, please wipe the blue area on the front of the wing with a damp paper towel. Soften the balsa wood to facilitate the installation of ribs on the back of the wing.

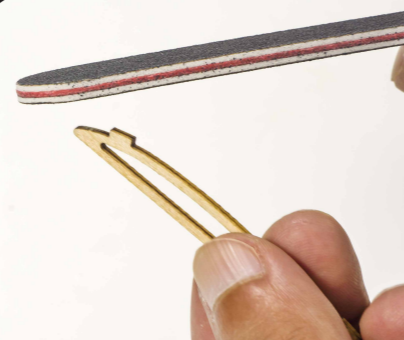

5



6

注意：安装机翼时，注意左右对称。Notes: Pay attention to the left and right symmetry when installing the wing.



7

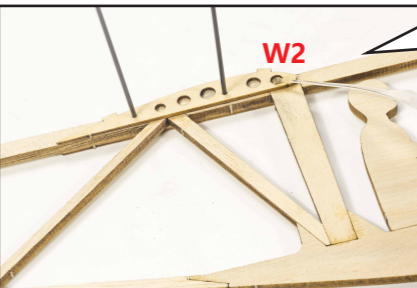

8

把连接处用胶水粘固。Fix the connection with glue.

利用碳杆定位，使用少量快干胶将翼肋 (W2) 定型，然后抽出碳杆，最后用胶水粘固。  
Use the carbon rod to position, use a small amount of quick-drying glue to shape the wing rib (W2), then pull out the carbon rod, and finally fix it with glue.

**注意 NOTE:**

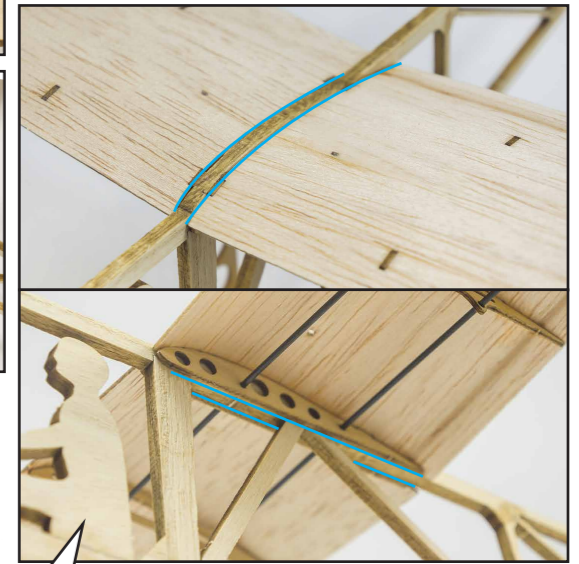

粘贴机翼时注意上图位置对齐。Pay attention to the position alignment in the picture above when pasting the wing.



9



10

平尾、垂尾安装细节。Installation Details for Flat and Vertical Tail.

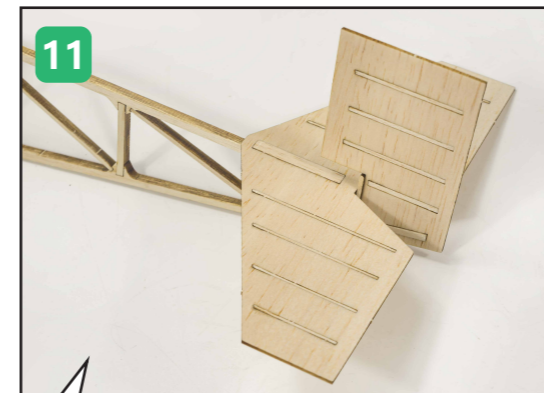

11

平尾、垂尾粘到机身，与机身保持垂直。Glue the horizontal and vertical tail to the fuselage and keep perpendicular to the fuselage.

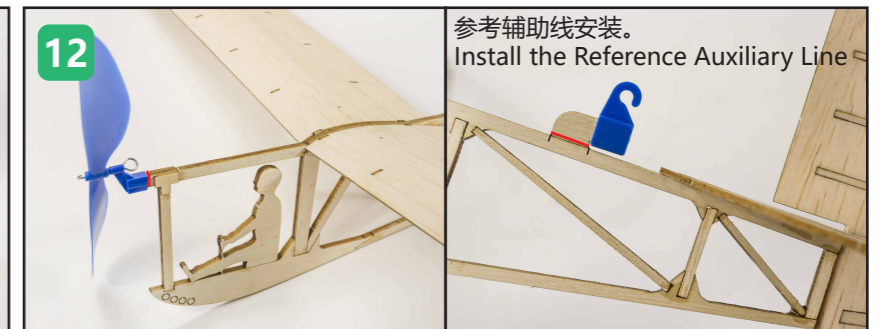

12

参考辅助线安装。Install the Reference Auxiliary Line



皮筋调整到微微绷紧状态，然后绑扎固定。皮筋建议绕两圈。Adjust the rubber band to a slightly tight state, and then tied and fixed. The rubber band is recommended to be wound twice.

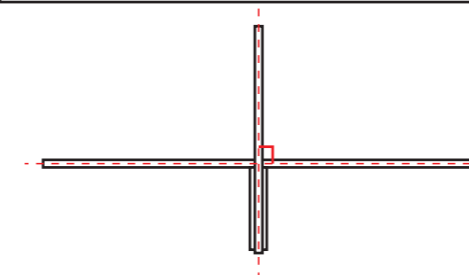



# VA04 1920'S POWER GLIDER

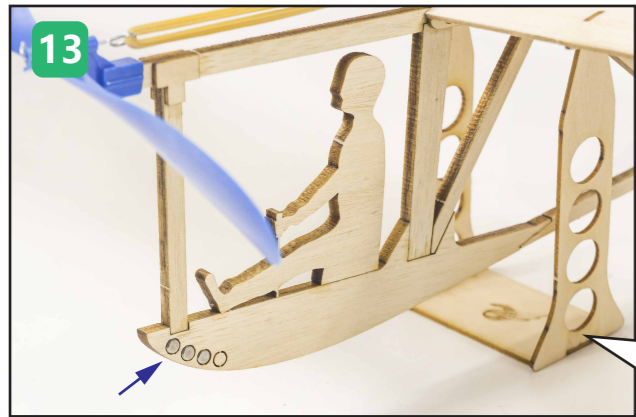

配重块放置位置  
Position for Counterweight Block

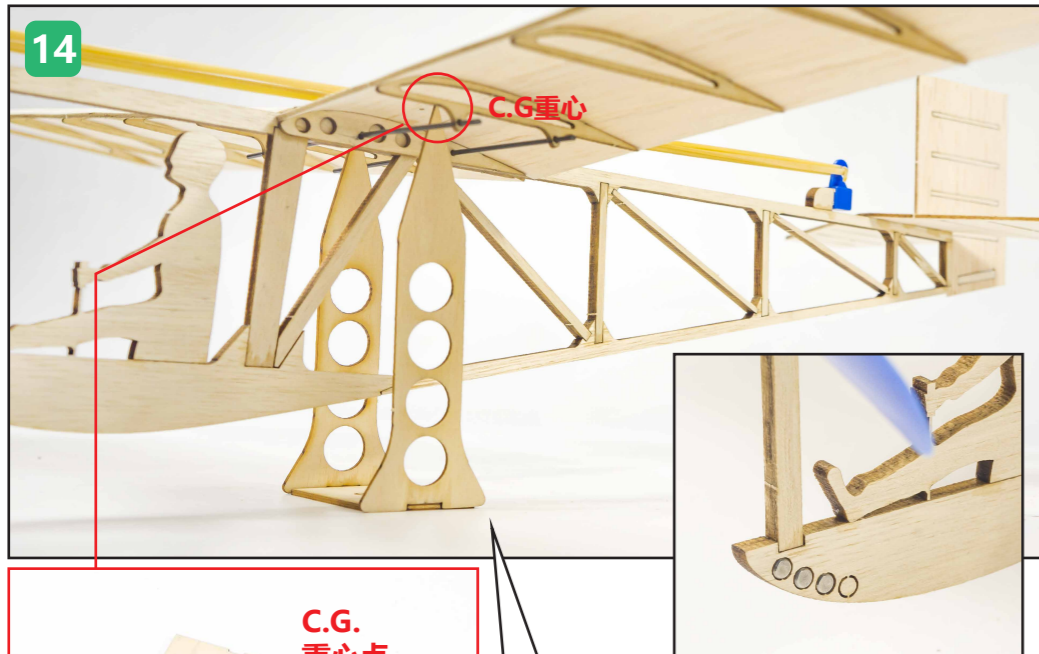

把整机放在调整支架上，并顶住重心位置，保持前后平衡。（通过头部放置配置块调整）  
Put the whole model on the adjustment bracket and hold the center of gravity to keep the front and back balance.  
(Adjust by placing the counterweight block on the head)



翼展: 638mm  
翼面积: 5.5dm<sup>2</sup>  
翼载荷: 6.9g/sq.dm<sup>2</sup>  
飞行重量: ≈38g

Wingspan: 638mm  
Wing area: 5.5 dm<sup>2</sup>  
Wing load: 6.9g/sq.dm<sup>2</sup>  
Flying weight: ≈38g

**飞行建议:**  
机头对自己，顺时针旋转200圈以上  
**Turn the nose towards yourself clockwise for more than 200 turns**

**如何修复:**  
**How to repair:**  
若不小心摔坏了，通常可以使用备料来修复破损的地方，这是一段快乐的时光。  
If you accidentally break it, you can usually use spare materials to repair the damaged place. This is a happy time.

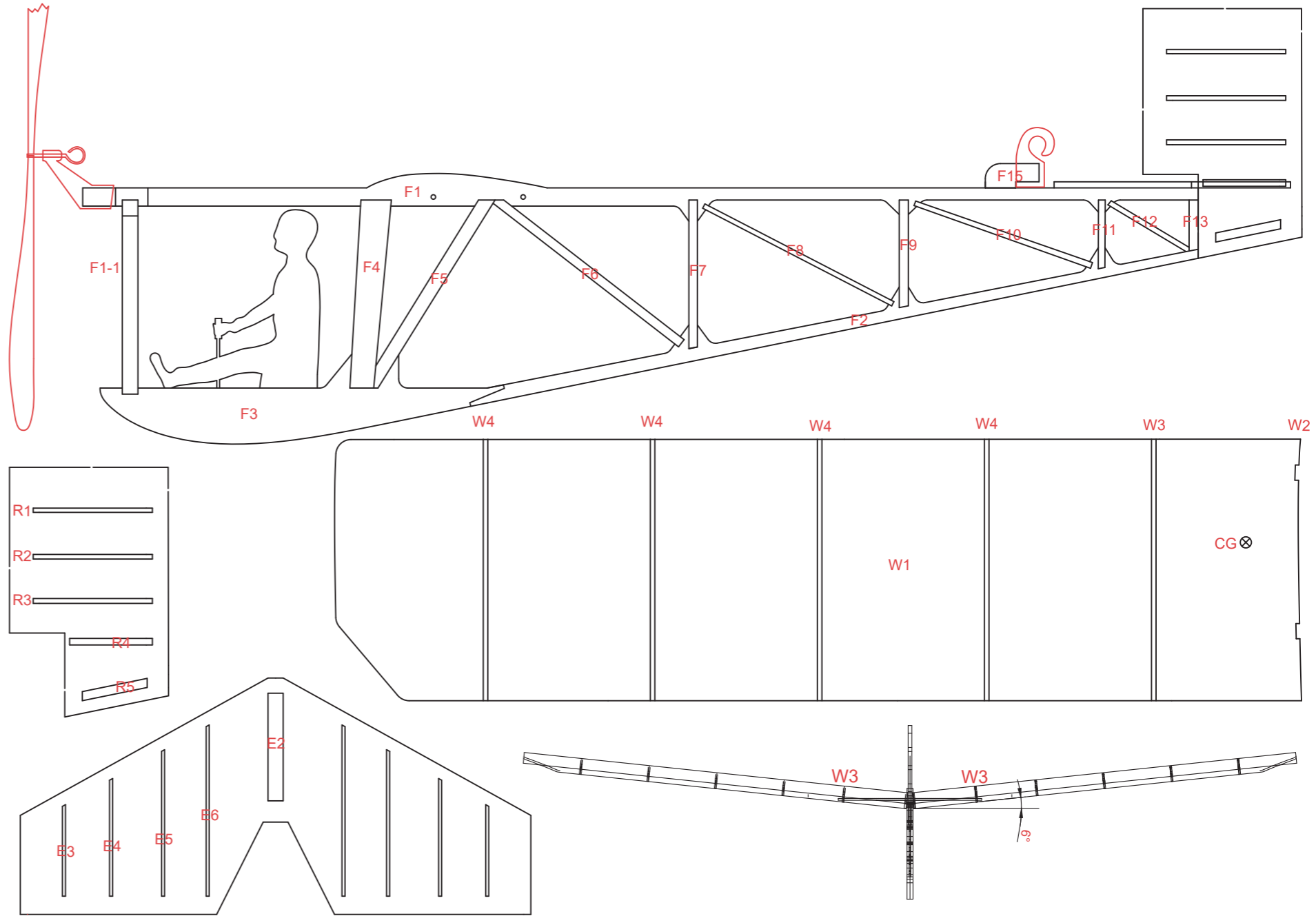

## Dancing Wings Hobby (DW HOBBY)

Dancing Wings Hobby (DWHOBBY) is a Chinese company specializing in manufacturing and producing the remote control aircraft models. The main business is to design the true-scale remote control fixed-wing models.

Different from the other manufacturers, the main direction of DWHOBBY's design is to pursue image fidelity and lightweight. We choose some classic, well-known models to restore their appearance as much as possible; In the process of design, we will try to use lightweight materials while ensuring the structural strength, which makes our design not only realistic in appearance, but also have good results in actual flight.

This is also where our products are unique and popular.

